

Werkstoff/Matière/Material
 AL = Aluminium/aluminium
 BE = Berylliumkupfer/cuivre béryllium/beryllium copper
 BZ = Bronze/bronze
 CU = Kupfer/cuivre/copper
 FS = Federstahl/Acier ressort/Spring steel
 HP = Hartpapier/papier dur/hard paper
 MS = Messing/laiton/brass
 PA = Polyamid/polyamide/polyamid
 PR = Pressspan/polyamide/Presspan
 PV = PVC/chlorure polyvinyle/polyvinylchlorid
 RF = rostfreier Stahl/acier inox/stainless steel
 ST = Stahl/Acier/Steel
 TF = PTFE/polytetrafluoréthylène/polytetrafluoréthylene

■ = Oberflächen/Surface/Surface-plating
 Seite/page/page 5.011

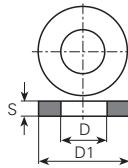

Werkstoff Matière Material	øD mm	øD1 mm	S mm	Artikelnummer Numéro d'article Part-No.	Werkstoff Matière Material	øD mm	øD1 mm	S mm	Artikelnummer Numéro d'article Part-No.
AL	3.2	6	1.5	p03206015010		12.4	25	0.8	p1242500805■
	3.2	7	0.4	p03207004010		15	28	1	p1502801005■
	3.2	7	0.5	p03207005010		15.3	18	0.3	p1531800305■
	3.2	7	0.6	p03207006010		HP	1.2	4.8	0.8
	3.2	7	1.5	p03207015010	1.3		2.5	0.3	p013025030hp
	4.2	10	0.8	p04210008010	1.5		3	0.3	p015030030hp
	6.2	10	0.5	p06210005010	1.6		6	0.3	p016060030hp
	BE	2.2	5	0.2	p0220500202■	2.2	4.5	0.5	p022045050hp
BZ		1.64	2.3	0.2	p0160230202■	2.2	5	0.3	p022050030hp
	FS	5.1	10	0.1	p0511000102■	2.2	5	0.5	p022050050hp
FS		2.2	5	0.1	p0220500105■	2.2	5.5	1	p022055100hp
	2.9	8	0.3	p0290800305■	2.5	5	0.3	p025050030hp	
	3.2	5.5	0.1	p0320550105■	2.5	5	0.5	p025050050hp	
	3.2	6	0.1	p0320600105■	2.8	4.5	0.5	p028045050hp	
	3.2	6	0.2	p0320600205■	2.8	5	0.3	p028050030hp	
	3.2	7	0.1	p0320700105■	2.8	5	0.5	p028050050hp	
	3.6	5.8	0.2	p0360580205■	2.8	5.5	0.5	p028055050hp	
	3.6	5.8	0.3	p0360580305■	2.8	6	0.8	p028060080hp	
	3.6	6	0.1	p0360600105■	2.8	6	1	p028060100hp	
	3.6	6	0.2	p0360600205■	2.8	8	0.5	p028080050hp	
	3.6	6	0.3	p0360600305■	3.2	6	0.2	p032060020hp	
	4.1	7	0.3	p0410700305■	3.2	6	0.5	p032060050hp	
	4.1	16	0.5	p0411600505■	3.2	6	1	p032060100hp	
	4.2	7	0.1	p0420700105■	3.2	6	1.5	p032060150hp	
	4.2	8	0.2	p0420800205■	3.2	8	1	p032080100hp	
	4.3	8	0.15	p0430800155■	3.2	9	0.5	p032090050hp	
	4.3	10	0.2	p0431000205■	3.2	10	1	p032100100hp	
	4.3	10	0.4	p0431000405■	3.2	10	2	p032100200hp	
	5.2	8	0.05	p0520800055■	3.2	12	1	p032120100hp	
	5.2	8	0.1	p0520800105■	3.2	13.8	2	p032138200hp	
	5.3	8	0.2	p0530800205■	3.2	30	1.5	p032300150hp	
	6.1	8.8	0.2	p0610880205■	3.3	8	1	p033080100hp	
	6.2	10	0.05	p0621000055■	3.7	7	0.8	p037070080hp	
	6.2	10	0.1	p0621000105■	3.7	9	0.8	p037090080hp	
	6.4	8	0.1	p0640800105■	4	6	1.5	p040060150hp	
	8	13.8	0.2	p0801380205■	4.2	5.5	0.5	p042055050hp	
	12.35	17.6	0.5	p1231760505■	4.2	6	0.2	p042060020hp	
						4.2	6	1	p042060100hp

Andere Abmessungen auf Anfrage

Autres dimensions sur demande

Further dimensions on request



Verbindungstechnik

Scheiben Rondelles Washers

Werkstoff Matière Material	øD mm	øD1 mm	S mm	Artikelnummer Numéro d'article Part-No.	Werkstoff Matière Material	øD mm	øD1 mm	S mm	Artikelnummer Numéro d'article Part-No.
	4.2	7	0.2	p042070020hp		3.2	6	0.3	p0320600306
	4.2	9	0.8	p042090080hp		3.2	6	0.5	p0320600506
	4.2	10	0.8	p042100080hp		3.2	6	0.8	p0320600806
	4.2	10	1	p042100100hp		3.2	6	1	p0320601006
	4.2	15	0.5	p042150050hp		3.2	7	0.5	p0320700506
	4.3	8	0.5	p043080050hp		3.2	8	0.1	p0320800106
	4.5	8	0.3	p045080030hp		3.2	8	0.2	p0320800206
	4.8	12	1	p048120100hp		3.2	8	0.3	p0320800306
	5.3	12	0.5	p053120050hp		3.2	8	0.5	p0320800506
	5.3	20	1.5	p053200150hp		3.2	12	1	p0321201006
	5.6	11	0.3	p056110030hp		3.7	6	0.5	p0370600506
	6	11	0.5	p060110050hp		3.7	7	0.5	p0370700506
	6	11	1.2	p060110120hp		3.7	8	0.5	p0370800506
	6	11	1.5	p060110150hp		4.2	6	0.5	p0420600506
	6.1	8.5	0.2	p061085020hp		4.2	6.4	0.5	p0420640506
	6.1	20	0.5	p061195050hp		4.2	7	0.5	p0420700506
	6.2	10	0.5	p062100050hp		4.2	7	1.2	p0420701206
	6.2	11	0.5	p062110050hp		4.2	8	0.5	p0420800506
	6.3	9	0.5	p063090050hp		4.2	8	0.8	p0420800806
	6.3	13	1	p063130100hp		4.2	9	0.6	p0420900606
	7	14	1.4	p070140140hp		4.2	10	0.5	p0421000506
	8	11	0.2	p080110020hp		4.2	10	0.8	p0421000806
	8	11	0.3	p080110030hp		4.3	6.5	0.5	p0430650506
	8	18	0.5	p080180050hp		4.3	7.5	0.5	p0430750506
	9	18	1.5	p090180150hp		4.3	8	0.5	p0430800506
	10	14	0.2	p100140020hp		4.3	12	1	p0431201006
	10.5	21	0.8	p105210080hp		5.2	8	0.7	p0520800706
	10.5	22	0.8	p105220080hp		5.3	8	0.5	p0530800506
	12.5	19	1	p125190100hp		5.3	8	0.8	p0530800806
	12.8	20	0.5	p128200050hp		5.3	9	0.5	p0530900506
CU	5.3	8	0.6	p0530800604		5.3	10	0.5	p0531000506
MS	1.5	2.5	0.4	p0150250406		5.3	10	0.8	p0531000806
	1.5	2.5	0.8	p0150250806		5.3	12	0.5	p0531200506
	1.5	3	0.3	p0150300306		5.3	12	0.8	p0531200806
	1.5	4.5	0.5	p0150450506		5.6	11	0.2	p0561100206
	1.8	4	0.3	p0180400306		6	16.9	0.5	p0601690506
	1.8	4.5	0.3	p0180450306		6.1	8.8	0.3	p0610880306
	1.8	5.5	0.5	p0180550506		6.1	8.8	0.5	p0610880506
	2.1	4	0.5	p0210400506		6.1	8.8	0.8	p0610880806
	2.1	6.5	0.4	p0210650406		6.2	10	0.5	p0621000506
	2.2	4.5	0.5	p0220450506		6.3	9	0.5	p0630900506
	2.2	4.8	0.3	p0220480306		6.3	9	0.8	p0630900806
	2.2	5.5	0.5	p0220550506		6.3	12	0.5	p0631200506
	2.2	5.5	1	p0220551006		6.3	14	1.5	p0631401506
	2.2	10	0.3	p0221000306		7.2	12	0.5	p0721200506
	2.5	5	0.4	p0250500406		8	11.5	1	p0801151006
	2.5	5	0.5	p0250500506		8	11.5	1.5	p0801151506
	2.5	6	0.5	p0250600506		8	12	1	p0801201006
	2.8	5	0.5	p0280500506		10.5	22	0.5	p1052200506
	2.8	5.5	0.5	p0280550506		12.4	23	0.5	p1242300506
	2.8	5.6	0.3	p0280560306		12.4	23	1.0	p1242301006
	2.8	7	0.5	p0280700506	PA	2.2	6	0.5	p022060050pa
	3	5	1	p0300501006		2.5	5	0.5	p025050050pa
	3.2	5	0.5	p0320500506		3.2	6	0.8	p032060080pa
	3.2	5.5	0.5	p0320550506		3.2	8	1	p032080100pa
	3.2	6	0.1	p0320600106					

Andere Abmessungen auf Anfrage

Autres dimensions sur demande

Further dimensions on request

Werkstoff/Matière/Material
 AL = Aluminium/aluminium
 BE = Berylliumkupfer/cuivre béryllium/beryllium copper
 BZ = Bronze/bronze
 CU = Kupfer/cuivre/copper
 FS = Federstahl/Acier ressort/Spring steel
 HP = Hartpapier/papier dur/hard paper
 MS = Messing/laiton/brass
 PA = Polyamid/polyamide/polyamid
 PR = Pressspan/polyamide/Presspan
 PV = PVC/chlorure polyvinyle/polyvinylchlorid
 RF = rostfreier Stahl/acier inox/stainless steel
 ST = Stahl/Acier/Steel
 TF = PTFE/polytetrafluoréthylène/polytetrafluoréthylene

■ = Oberflächen/Surface/Surface-plating
 Seite/page/page 5.011

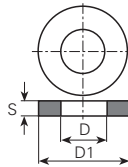

Werkstoff Matière Material	øD mm	øD1 mm	S mm	Artikelnummer Numéro d'article Part-No.	Werkstoff Matière Material	øD mm	øD1 mm	S mm	Artikelnummer Numéro d'article Part-No.
	3.2	8	3	p032080300pa		4.2	8	0.5	p042080050pr
PR	4.2	8	1	p042080100pr		4.2	10	0.5	p042100050pr
PA	4.2	10	0.25	p042100025pa		4.2	10	1	p042100100pr
	4.5	8	0.3	p045080030pa		4.8	12	0.8	p048120080pr
	4.5	8	0.5	p045080050pa		5.3	8	0.5	p053080050pr
	5.3	8	0.5	p053080050pa		5.3	8	1	p053080100pr
	5.5	16	0.4	p055160040pa		5.3	11	0.5	p053110050pr
	5.5	19	1	p055190100pa		5.3	12	1	p053120100pr
	6.5	12	0.5	p065120050pa		6.3	10	0.6	p063100060pr
	6.5	12	1	p065120100pa		6.3	12	0.5	p063120050pr
PV	4.2	7	0.5	p042070050pv		6.4	11	1.6	p064110160pr
	5	11	2	p050110200pv		6.4	12	1	p064120100pr
PR	1.2	3	0.3	p012030030pr		7	14	1.5	p070140150pr
	1.5	3	0.5	p015030050pr		8.2	15	1	p082150100pr
	1.6	6	0.5	p016060050pr		9	12	0.3	p090120030pr
	1.8	3	0.5	p018030050pr		9.2	11.6	0.3	p092116030pr
	1.8	4	0.5	p018040050pr		10	21	1	p100210100pr
	1.8	4.5	0.5	p018045050pr		12.5	19	1	p125190100pr
	2.2	4	0.5	p022040050pr		14.2	24.8	1	p142248100pr
	2.4	5	0.5	p024050050pr	RF	3.1	5.05	0.3	p03105003080
	2.5	5	0.5	p025050050pr		3.2	6	0.5	p03206005080
	2.5	8	0.8	p025080080pr		3.2	10	1	p03210010080
	2.8	4.5	0.5	p028045050pr		4.1	11	1	p04111010080
	2.8	5.5	0.3	p028055030pr		4.2	8	0.1	p04208001080
	2.8	5.5	0.5	p028055050pr		4.2	8	1	p04208010080
	2.8	6.5	0.5	p028065050pr		5.3	8	0.1	p05308001080
	2.8	7	0.5	p028070050pr		5.3	8	0.2	p05308002080
	3.2	5	0.5	p032050050pr		5.6	8	0.4	p05608004080
	3.2	6	0.5	p032060050pr		6.2	12	0.2	p06212002080
	3.2	6	0.8	p032060080pr		12	17	0.5	p12017005080
	3.2	6	1.5	p032060150pr		13.7	24	0.5	p13724005080
	3.2	7	1	p032070100pr	16	28	1.5	p16028015080	
3.2	7	2	p032070200pr	ST	1.8	4	0.3	p0180400309■	
3.2	8	0.5	p032080050pr		1.8	4.5	0.3	p0180450309■	
3.2	8	1	p032080100pr		2.1	5	0.5	p0210500509■	
3.2	8	1.5	p032080150pr		2.2	4.5	0.5	p0220450509■	
3.5	7	0.5	p035070050pr		2.2	5.5	0.5	p0220550509■	
3.7	7	0.8	p037070080pr		2.5	6	0.5	p0250600509■	

Andere Abmessungen auf Anfrage

Autres dimensions sur demande

Further dimensions on request

Werkstoff Matière Material	øD mm	øD1 mm	S mm	Artikelnummer Numéro d'article Part-No.	Werkstoff Matière Material	øD mm	øD1 mm	S mm	Artikelnummer Numéro d'article Part-No.
	2.7	6	0.5	p0270600509		5.3	10	0.5	p0531000509
	2.8	5.5	0.5	p0280550509		5.3	10	0.8	p0531000809
	2.8	6.5	2	p0280652009		5.3	10	1	p0531001009
	2.8	7	0.4	p0280700409		5.3	11	0.5	p0531100509
	2.8	7	0.5	p0280700509		5.3	11	1	p0531101009
	3.2	5	0.5	p0320500509		5.3	12	0.5	p0531200509
	3.2	5.6	0.3	p0320560309		5.3	12	1	p0531201009
	3.2	6	0.5	p0320600509		6.2	10	0.3	p0621000309
	3.2	6	0.8	p0320600809		6.2	12	1	p0621201009
	3.2	7	0.5	p0320700509		6.3	8	0.5	p0630800509
	3.2	7	1.5	p0320701509		6.3	9	0.5	p0630900509
	3.2	8	0.5	p0320800509		6.4	10	0.8	p0641000809
	3.2	8	1.2	p0320801209		6.4	14	1	p0641401009
	3.2	8	1.5	p0320801509		6.4	14	1.5	p0641401509
	3.2	9	0.5	p0320900509		7.2	12	0.3	p0721200309
	3.2	9	1	p0320901009		8	11	1	p0801101009
	3.2	10	0.8	p0321000809		8	14	0.8	p0801400809
	3.2	10	1	p0321001009		8.1	10.8	0.5	p0811080509
	3.7	6	0.5	p0370600509		8.1	12	0.2	p0811200209
	3.7	7	0.5	p0370700509		9	11.5	0.5	p0901150509
	3.7	8	0.5	p0370800509		9.2	13	1.6	p0921301609
	4.1	7	0.7	p0410700709		9.2	13	2	p0921302009
	4.15	11	1	p0411101009		9.5	12	0.5	p0951200509
	4.2	6	0.5	p0420600509		10	15	0.5	p1001500509
	4.2	7	0.5	p0420700509		10	21	1	p1002101009
	4.2	8	0.5	p0420800509		13	21	0.3	p1302100309
	4.2	8	0.8	p0420800809		13	21	0.5	p1302100509
	4.2	8	1.2	p0420801209		16.5	25	0.8	p1652500809
	4.2	9	0.5	p0420900509		18	24	2	p1802402009
	4.2	9	0.8	p0420900809		32.1	37	1.5	p3213701509
	4.2	10	0.5	p0421000509	TF	2.8	4.5	0.5	p028045050tf
	4.2	10	0.8	p0421000809		3	5	0.1	p030050010tf
	4.2	14	1.5	p0421401509		3	5	0.5	p030050050tf
	4.6	7	0.6	p0460700609		6	16	1	p060160100tf
	5	11	1	p0501101009		6.2	20	1	p062200100tf
	5.3	8	0.2	p0530800209					
	5.3	8	0.5	p0530800509					

Andere Abmessungen auf Anfrage

Autres dimensions sur demande

Further dimensions on request