

# Steckhülsen 2,8 mm

## Clips femelles

### Receptacles

DIN 46247/1

\* ausgenommen  
\* excepté  
\* excepted

Werkstoff/Matière/Material  
.2 = Bronze/bronze  
.6 = Messing/laiton/brass

■ = Oberflächen/Surface/Surface-plating  
Seite/page/page 5.011

Strombelastbarkeit / Intensité admissible / Current carrying capacity:  
0.3 – 0.5 mm<sup>2</sup> / 2.5 A max.  
0.5 – 1.0 mm<sup>2</sup> / 6.0 A max.

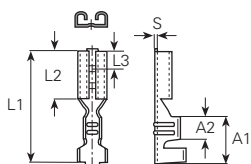

mm <sup>2</sup>	AWG	Größe Grandeur Size	Artikelnummer Numéro d'article Part-No.	DIN	L1 mm	L2 mm	L3 mm	A1 mm	A2 mm	S mm	Werkzeuge Outils Toolings
<b>0.14-0.3</b>	26-24	<b>2.8 x 0.5</b>	<b>3760a.6</b> ■	*	14	6.3		5	2	0.25	<b>3975b, 3984g</b>
	26-24	<b>2.8 x 0.8</b>	<b>3762a.6</b> ■	*	14	6.3		5	2	0.25	
	26-24	<b>2.8 x 1.2</b>	<b>3762c.6</b> ■	*	14	6.3		5	2	0.25	
<b>0.3-0.5</b>	24-22	<b>2.8 x 0.5</b>	<b>3760b.6</b> ■	46247/T1	14	6.3	3.3	5.5	2.9	0.25	<b>3975b, 3984g</b>
	24-22	<b>2.8 x 0.8</b>	<b>3762b.2</b> ■	46247/T1	14	6.3	3.3	5.5	2.9	0.25	
	24-22	<b>2.8 x 0.8</b>	<b>3762b.6</b> ■	46247/T1	14	6.3	3.3	5.5	2.9	0.25	
<b>0.5-1</b>	22-18	<b>2.8 x 0.5</b>	<b>3764.6</b> ■	46330/T2	12.5	5	3.3	5.5	2.5	0.25	<b>3975b, 3984a, 3988n</b>
	22-18	<b>2.8 x 0.8</b>	<b>3765.6</b> ■	46330/T2	12.5	5	3.3	5.5	2.9	0.3	
	22-18	<b>2.8 x 0.5</b>	<b>3766.6</b> ■	46247/T1	14	6.3	3.3	5.5	2.9	0.25	
	22-18	<b>2.8 x 0.8</b>	<b>3767.2</b> ■	46247/T1	14	6.3	3.3	5.5	2.9	0.25	
22-18	<b>2.8 x 0.8</b>	<b>3767.6</b> ■	46247/T1	14	6.3	3.3	5.5	2.9	0.25		

Werkstoff/Matière/Material  
.6 = Messing/laiton/brass

■ = Oberflächen/Surface/Surface-plating  
Seite/page/page 5.011

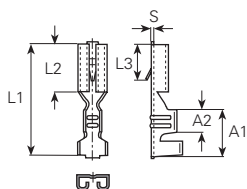

mm <sup>2</sup>	AWG	Größe Grandeur Size	Artikelnummer Numéro d'article Part-No.	DIN	L1 mm	L2 mm	L3 mm	A1 mm	A2 mm	S mm	Werkzeuge Outils Toolings
<b>0.14-0.3</b>	26-24	<b>2.8 x 0.8</b>	<b>3763a.6</b> ■	46340/T1	14	6.3	5.6	5.5	2.5	0.25	<b>3975b, 3984g</b>
<b>0.5-1</b>	22-18	<b>2.8 x 0.8</b>	<b>3769.6</b> ■	*	15.5	8	8.3	5.5	2.5	0.3	<b>3975b, 3984a, 3988n</b>

Werkstoff/Matière/Material  
.6 = Messing/laiton/brass

■ = Oberflächen/Surface/Surface-plating  
Seite/page/page 5.011

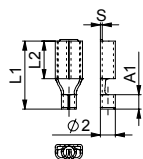

mm <sup>2</sup>	AWG	Größe Grandeur Size	Artikelnummer Numéro d'article Part-No.	DIN	L1 mm	L2 mm	L3 mm	A1 mm	A2 mm	S mm	Werkzeuge Outils Toolings
<b>0.5-1</b>	22-18	<b>2.8 x 0.5</b>	<b>3761a.6</b> ■	*	9	5		1.9		0.25	<b>3975b, 3988n</b>
	22-18	<b>2.8 x 0.8</b>	<b>3761.6</b> ■	*	9	5		1.9		0.25	

Werkstoff/Matière/Material  
.6 = Messing/laiton/brass

■ = Oberflächen/Surface/Surface-plating  
Seite/page/page 5.011

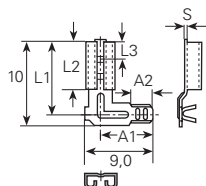

mm <sup>2</sup>	AWG	Größe Grandeur Size	Artikelnummer Numéro d'article Part-No.	DIN	L1 mm	L2 mm	L3 mm	A1 mm	A2 mm	S mm	Werkzeuge Outils Toolings
<b>0.5-1</b>	22-18	<b>2.8 x 0.5</b>	<b>3764w.6</b> ■	*	8	5	3.3	7.2	2.5	0.3	<b>3973b</b>
	22-18	<b>2.8 x 0.8</b>	<b>3765w.6</b> ■	*	8	5	3.3	7.2	2.5	0.3	

## Steckhülsen und Steckverteiler 2,8 mm

### Clips femelles et raccords mixtes

### Receptacles and multi connectors

Werkstoff/Matière/Material  
 .2 = Bronze/bronze  
 .6 = Messing/laiton/brass

■ = Oberflächen/Surface/Surface-plating  
 Seite/page/page 5.011

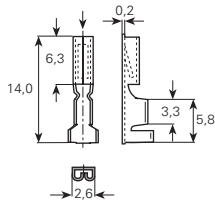

Artikelnummer  
 Numéro d'article  
 Part-No.  
 Grösse  
 Grandeur  
 Size

**3758.6**  
 2.0 x 0.3  
 mm<sup>2</sup> **0.3-0.5**  
 AWG 24-22

Werkzeuge  
 Outils  
 Toolings

**3975b, 3984g**

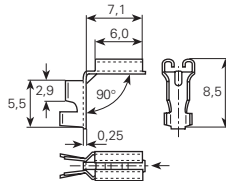

**3766w.2**  
 2.8 x 0.5

mm<sup>2</sup> **0.5-1**  
 AWG 22-18

**3975b**

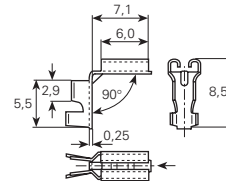

**3766w.6**  
 2.8 x 0.5

mm<sup>2</sup> **0.5-1**  
 AWG 22-18

**3975b**

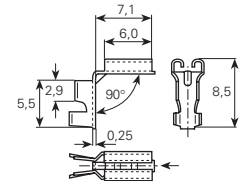

**3767w.2**  
 2.8 x 0.8

mm<sup>2</sup> **0.5-1**  
 AWG 22-18

**3975b**

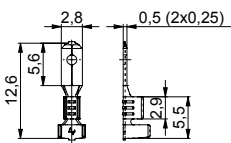

Artikelnummer  
 Numéro d'article  
 Part-No.  
 Grösse  
 Grandeur  
 Size

**379905.6**  
 2.8 x 0.5  
 mm<sup>2</sup> **0.5-1**  
 AWG 22-18

Werkzeuge  
 Outils  
 Toolings

**3975b**

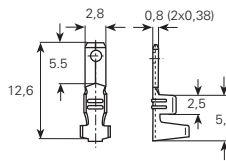

**379908.6**  
 2.8 x 0.8

mm<sup>2</sup> **0.5-1**  
 AWG 22-18

**3975b, 3984a, 3988n**

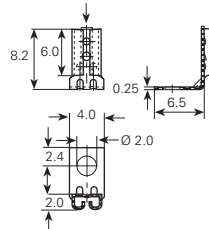

**3762g.6**  
 2.8 x 0.8

mm<sup>2</sup>  
 AWG

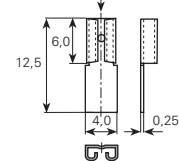

**3762e.6**  
 2.8 x 0.5

mm<sup>2</sup>  
 AWG

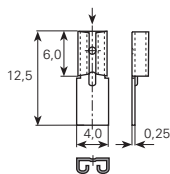

Artikelnummer  
 Numéro d'article  
 Part-No.  
 Grösse  
 Grandeur  
 Size

**3762f.6**  
 2.8 x 0.8  
 mm<sup>2</sup>  
 AWG

Werkzeuge  
 Outils  
 Toolings

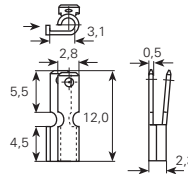

**378105.6**  
 2.8 x 0.5 / 2.8 x 0.5  
 mm<sup>2</sup>  
 AWG

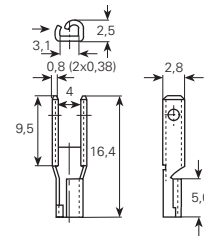

**378108.6**  
 2.8 x 0.8 / 2.8 x 0.8  
 mm<sup>2</sup>  
 AWG

# Steckhülsen 4,8 mm

## Clips femelles

## Receptacles

DIN 46247/2

\* ausgenommen  
\* excepté  
\* excepted

Werkstoff/Matière/Material  
.6 = Messing/laiton/brass

■ = Oberflächen/Surface/Surface-plating  
Seite/page/page 5.011

Strombelastbarkeit / Intensité admissible / Current carrying capacity:  
0.5 – 1.0 mm<sup>2</sup> / 10A max.  
1.5 – 2.5 mm<sup>2</sup> / 15A max.

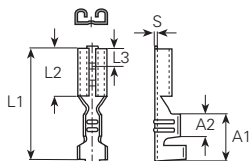

mm <sup>2</sup>	AWG	Grösse Grandeur Size	Artikelnummer Numéro d'article Part-No.	DIN	L1 mm	L2 mm	L3 mm	A1 mm	A2 mm	S mm	Werkzeuge Outils Toolings
0.5-1	22-18	4.8 x 0.5	3800.6■	*	15.5	6.3	3.8	6.7	3.3	0.35	3975b,
	22-18	4.8 x 0.8	3801.6■	46247/T2	16	6	3.8	6.3	3.5	0.35	3984a, 3988n
1.5-2.5	16-14	4.8 x 0.5	3803.6■	*	15.5	6.3	3.8	6.7	3.3	0.35	3975c,
	16-14	4.8 x 0.8	3805.6■	46247/T2	15.6	6	3.8	6	3.4	0.35	3983p.4, 3984a, 3988n

Werkstoff/Matière/Material  
.6 = Messing/laiton/brass

■ = Oberflächen/Surface/Surface-plating  
Seite/page/page 5.011

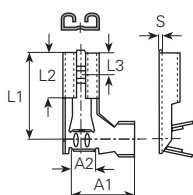

mm <sup>2</sup>	AWG	Grösse Grandeur Size	Artikelnummer Numéro d'article Part-No.	DIN	L1 mm	L2 mm	L3 mm	A1 mm	A2 mm	S mm	Werkzeuge Outils Toolings
0.5-1	22-18	4.8 x 0.5	380205.6■	*	11.3	6	3.8	8.3	3	0.35	3983d
	22-18	4.8 x 0.8	380208.6■	*	11.3	6	3.8	8.3	3	0.35	

Werkstoff/Matière/Material  
.6 = Messing/laiton/brass

■ = Oberflächen/Surface/Surface-plating  
Seite/page/page 5.011

### Flachstecker

### Languettes plates

### tabs

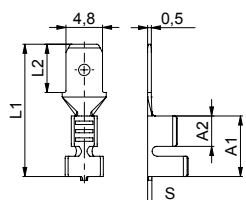

mm <sup>2</sup>	AWG	Grösse Grandeur Size	Artikelnummer Numéro d'article Part-No.	DIN	L1 mm	L2 mm	L3 mm	A1 mm	A2 mm	S mm	Werkzeuge Outils Toolings
0.75-2	20-15	4.8 x 0.5	3807.6■	*	17.5	6.4		8	4	0.5	3975f

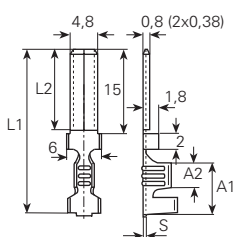

mm <sup>2</sup>	AWG	Grösse Grandeur Size	Artikelnummer Numéro d'article Part-No.	DIN	L1 mm	L2 mm	L3 mm	A1 mm	A2 mm	S mm	Werkzeuge Outils Toolings
1.5-2.5	16-14	4.8 x 0.8	3808.6■	*	26.5	14.5		6.5	3.5	0.38	3975c, 3983p.4, 3984a, 3988n

# Steckhülsen und Steckverteiler 4,8 mm

## Clips femelles et raccords mixtes

### Receptacles and multi connectors

Werkstoff/Matière/Material  
.6 = Messing/laiton/brass

■ = Oberflächen/Surface/Surface-plating  
Seite/page/page 5.011

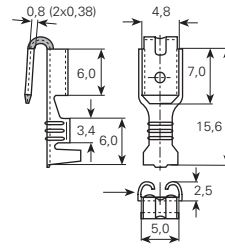
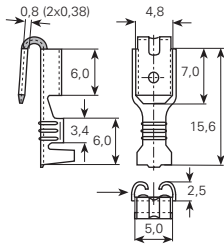

Artikelnummer  
Numéro d'article  
Part-No.  
Größe  
Grandeur  
Size

**3829a.6**

4.8 x 0.8 / 4.8 x 0.8

mm<sup>2</sup> 0.5-1

AWG 22-18

Werkzeuge  
Outils  
Toolings

**3975b, 3984a, 3988n**

**3829b.6**

4.8 x 0.8 / 4.8 x 0.8

mm<sup>2</sup> 1.5-2.5

AWG 16-14

**3975c, 3983p.4, 3984a, 3988n**

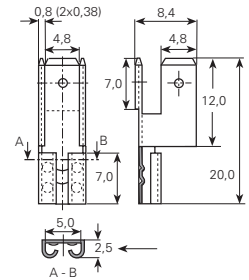
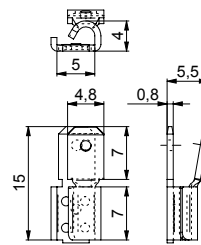
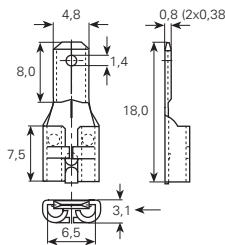
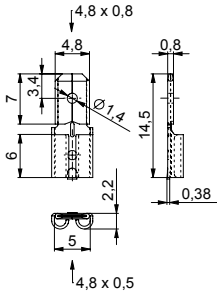
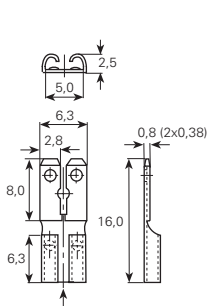

Artikelnummer  
Numéro d'article  
Part-No.  
Größe  
Grandeur  
Size

**3829c.6**

4.8 x 0.8 / 6.3 x 0.8

mm<sup>2</sup>

AWG

Werkzeuge  
Outils  
Toolings

**3829f.6**

4.8 x 0.5 / 4.8 x 0.8

mm<sup>2</sup>

AWG

**3829g.6**

6.3 x 0.8 / 4.8 x 0.8

mm<sup>2</sup>

AWG

**3829.6**

4.8 x 0.8 / 4.8 x 0.8

mm<sup>2</sup>

AWG

**3829e.6**

4.8 x 0.8 / 4.8 x 0.8

mm<sup>2</sup>

AWG

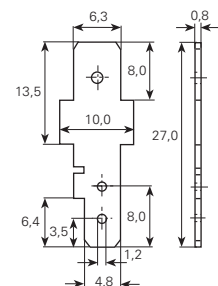
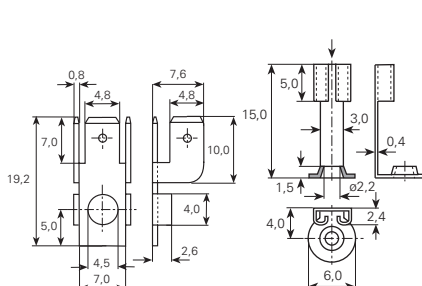
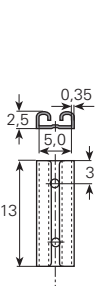
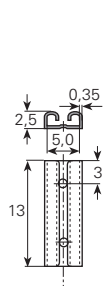

Artikelnummer  
Numéro d'article  
Part-No.  
Größe  
Grandeur  
Size

**3829k05.6**

4.8 x 0.5 / 4.8 x 0.5

mm<sup>2</sup>

AWG

Werkzeuge  
Outils  
Toolings

**3829k08.6**

4.8 x 0.8 / 4.8 x 0.8

mm<sup>2</sup>

AWG

**3829h.6**

4.8 x 0.8 / 4.8 x 0.8

mm<sup>2</sup>

AWG

**3829d.6**

4.8 x 0.8

mm<sup>2</sup>

AWG

**3839d.6**

6.3 x 0.8 / 4.8 x 0.8

mm<sup>2</sup>

AWG

# Steckhülsen 6,3 mm

## Clips femelles

## Receptacles

DIN 46247/3

\* ausgenommen  
\* excepté  
\* excepted

Werkstoff/Matière/Material  
.2 = Bronze/bronze  
.6 = Messing/laiton/brass  
.9 = Stahl/acier/steel

■ = Oberflächen/Surface/Surface-plating  
Seite/page/page 5.011

Strombelastbarkeit / Intensité admissible / Current carrying capacity:  
0.5 – 1.0 mm<sup>2</sup> / 10A max.  
1.5 – 2.5 mm<sup>2</sup> / 15A max.  
4.0 – 6.0 mm<sup>2</sup> / 25A max

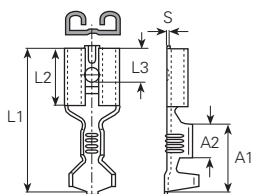

mm <sup>2</sup>	AWG	Grösse Grandeur Size	Artikelnummer Numéro d'article Part-No.	DIN	L1 mm	L2 mm	L3 mm	A1 mm	A2 mm	S mm	Werkzeuge Outils Toolings
<b>0.5-1</b>	22-18	<b>6.3 x 0.8</b>	<b>3831.6</b> ■	46247/T3	19	7.5	4	8.3	4.5	0.45	<b>3983p.4,</b> <b>3984a, 3988n</b>
	22-18	<b>6.3 x 0.8</b>	<b>3831.9</b> ■	46247/T3	19	7.5	4	9	4.5	0.45	
<b>0.5-1.5</b>	22-16	<b>6.3 x 0.8</b>	<b>3832.6</b> ■	46247/T3	19	7.5	4	9	4.5	0.45	<b>3975c,</b> <b>3983p.4,</b> <b>3984a, 3988n</b>
	22-16	<b>6.3 x 0.8</b>	<b>3832.9</b> ■	46247/T3	19	7.5	4	9	4.5	0.45	
<b>1-2.5</b>	18-14	<b>6.3 x 0.8</b>	<b>3833.2</b> ■	46247/T3	19	7.5	4	8.5	4	0.4	<b>3975c,</b> <b>3983p.4,</b> <b>3984a, 3988n</b>
	18-14	<b>6.3 x 0.8</b>	<b>3833.6</b> ■	46247/T3	19	7.5	4	8.5	4	0.4	
	18-14	<b>6.3 x 0.8</b>	<b>3833.9</b> ■	46247/T3	19	7.5	4	8.5	4	0.4	
<b>4-6</b>	12-10	<b>6.3 x 0.8</b>	<b>3835a.6</b> ■	46247/T3	19	7.5	4	9	4.5	0.45	<b>3975c,</b> <b>3983p.4,</b> <b>3984b, 3988n</b>

Werkstoff/Matière/Material  
.6 = Messing/laiton/brass

■ = Oberflächen/Surface/Surface-plating  
Seite/page/page 5.011

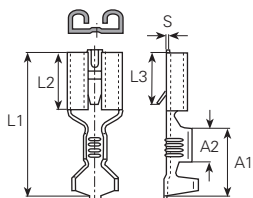

mm <sup>2</sup>	AWG	Grösse Grandeur Size	Artikelnummer Numéro d'article Part-No.	DIN	L1 mm	L2 mm	L3 mm	A1 mm	A2 mm	S mm	Werkzeuge Outils Toolings
<b>1-2.5</b>	18-14	<b>6.3 x 0.8</b>	<b>3832d.6</b> ■	46340/T3	19	7.5	7.3	8.5	4	0.4	<b>3975c,</b> <b>3983p.4,</b> <b>3984a, 3988n</b>

Werkstoff/Matière/Material  
.6 = Messing/laiton/brass  
.9 = Stahl/acier/steel

■ = Oberflächen/Surface/Surface-plating  
Seite/page/page 5.011

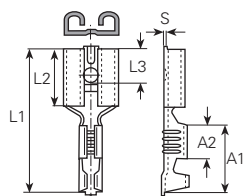

mm <sup>2</sup>	AWG	Grösse Grandeur Size	Artikelnummer Numéro d'article Part-No.	DIN	L1 mm	L2 mm	L3 mm	A1 mm	A2 mm	S mm	Werkzeuge Outils Toolings
<b>4-6</b>	12-10	<b>6.3 x 0.8</b>	<b>3835.6</b> ■	46247/T3	19	7.5	4	9	4.5	0.45	<b>3975c,</b> <b>3983p.4,</b> <b>3984b, 3988n</b>
	12-10	<b>6.3 x 0.8</b>	<b>3835.9</b> ■	46247/T3	19	7.5	4	9	4.5	0.45	

# Steckhülsen 6,3 mm

## Clips femelles

## Receptacles

DIN 46247/3

\* ausgenommen  
\* excepté  
\* excepted

Werkstoff/Matière/Material  
.6 = Messing/laiton/brass

■ = Oberflächen/Surface/Surface-plating  
Seite/page/page 5.011

Strombelastbarkeit / Intensité admissible / Current carrying capacity:  
0.5 – 1.0 mm<sup>2</sup> / 10A max.  
1.5 – 2.5 mm<sup>2</sup> / 15A max.

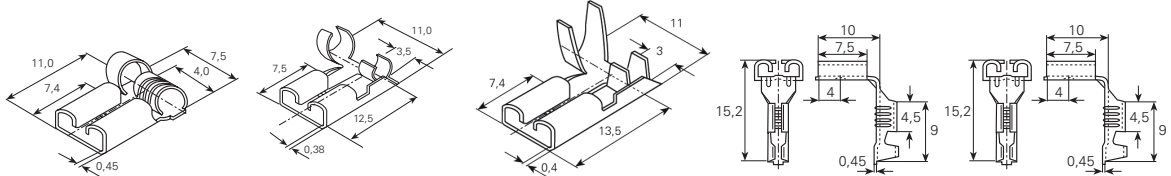

Artikelnummer Numéro d'article Part-No. Grösse Grandeur Size	38371a.6	38372c.6	38373c.6	3832w.6	3833w.6
	6.3 x 0.8	6.3 x 0.8	6.3 x 0.8	6.3 x 0.8	6.3 x 0.8
mm <sup>2</sup>	0.5-1.5	0.5-1	1.5-2.5	0.5-1.0	1.5-2.5
AWG	22-16	22-18	16-14	22-18	16-14
DIN	46346/B	46346/A	46346/A	DIN	DIN
Werkzeuge Outils Toolings	3983an, 3984k	3983bn, 3984m	3983cn, 3984n	3983p.4, 3984a, 3988n	3975c, 3983p.4, 3984a, 3988n

Werkstoff/Matière/Material  
.6 = Messing/laiton/brass

■ = Oberflächen/Surface/Surface-plating  
Seite/page/page 5.011

### Flachstecker

### Languettes plates

### tabs

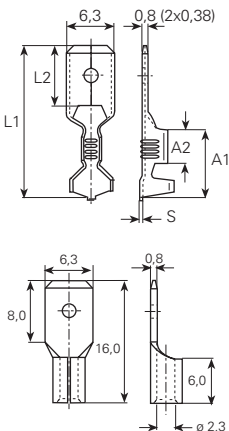

mm <sup>2</sup>	AWG	Grösse Grandeur Size	Artikelnummer Numéro d'article Part-No.	DIN	L1 mm	L2 mm	A1 mm	A2 mm	S mm	Werkzeuge Outils Toolings
0.5-1	22-18	6.3 x 0.8	3836a.6	46248/T3	20	8.5	8.5	4.6	0.4	3983p.4, 3984a, 3988n
1.5-2.5	16-14	6.3 x 0.8	3836b.6	46248/T3	20	8	8.5	4.6	0.38	3975c, 3983p.4, 3984a, 3988n
4-6	12-10	6.3 x 0.8	3836c.6	46248/T3	20	8	8.5	4.6	0.38	3975c, 3983p.4, 3984b, 3988n

mm <sup>2</sup>	AWG	Grösse Grandeur Size	Artikelnummer Numéro d'article Part-No.	DIN	L1 mm	L2 mm	A1 mm	A2 mm	S mm	Werkzeuge Outils Toolings
1.5-2.5	16-14	6.3 x 0.8	3836d.6	*						

Werkstoff/Matière/Material  
.2 = Bronze/bronze  
.6 = Messing/laiton/brass

■ = Oberflächen/Surface/Surface-plating  
Seite/page/page 5.011

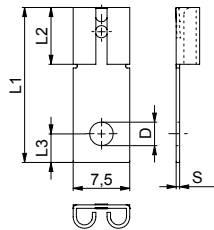

**\* = ohne Bohrung / \* = sans trou / \* = without hole**

Größe Grandeur Size	Artikelnummer Numéro d'article Part-No.	L1 mm	L2 mm	L3 mm	øD mm	S mm
6.3 x 0.8	3839m.6■	20.5	7.5	3.8	3.6	0.45
	3839n.6■	20.5	7.5	3.8	4.3	0.45
	3839t.6■	20.5	7.5	-	*	0.45
	3839u.2■	20.5	7.5	3.8	3.1	0.45
	3839u.6■	20.5	7.5	3.8	3.1	0.45

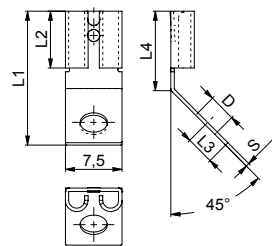

Größe Grandeur Size	Artikelnummer Numéro d'article Part-No.	L1 mm	L2 mm	L3 mm	øD mm	S mm
6.3 x 0.8	3839u45.6■	17.7	7.5	3.8	3.1	0.45
	3839t45.6■	17.7	7.5	-	*	0.45
	3839n45.6■	17.7	7.5	3.8	4.3	0.45
	3839m45.6■	17.7	7.5	3.8	3.6	0.45

Werkstoff/Matière/Material  
.6 = Messing/laiton/brass  
.9 = Stahl/acier/steel

■ = Oberflächen/Surface/Surface-plating  
Seite/page/page 5.011

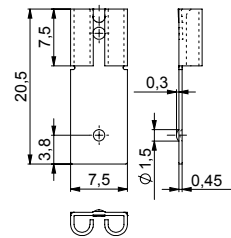

Artikelnummer  
Numéro d'article  
Part-No.  
Größe  
Grandeur  
Size

3839s.6■  
6.3 x 0.8

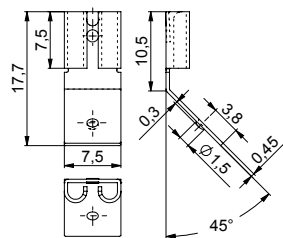

3839s45.6■  
6.3 x 0.8

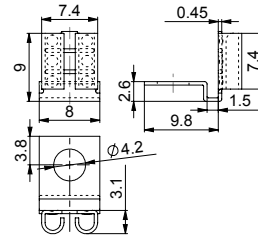

3839w.6■  
6.3 x 0.8

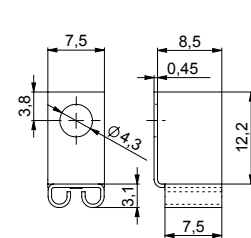

3839b90.6■  
6.3 x 0.8

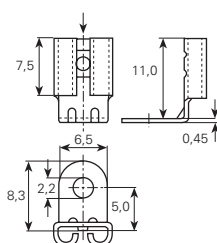

Artikelnummer  
Numéro d'article  
Part-No.  
Größe  
Grandeur  
Size

3839c.6■  
6.3 x 0.8

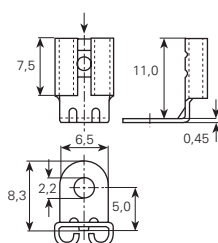

3839c.9■  
6.3 x 0.8

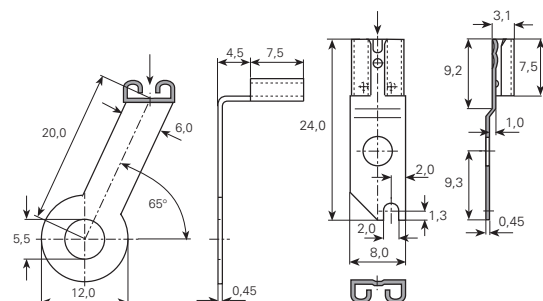

3839p.6■  
6.3 x 0.8

3839r.6■  
6.3 x 0.8

# Steckhülsen und Steckverteiler 6,3 mm

## Clips femelles et raccords mixtes

### Receptacles and multi connectors

Masse im Steckbereich DIN  
46342, Teil 1

Dimensions zone  
d'emboîtement selon DIN  
46342, partie 1

Dimensions in the tab sector  
DIN 46342, part 1

Werkstoff/Matière/Material  
.2 = Bronze/bronze  
.4 = Kupfer/cuivre/copper  
.6 = Messing/laiton/brass  
.8 = rostfreier Stahl/acier inox/stainless steel  
.9 = Stahl/acier/steel

■ = Oberflächen/Surface/Surface-plating  
Seite/page/page 5.011

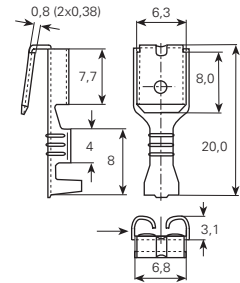
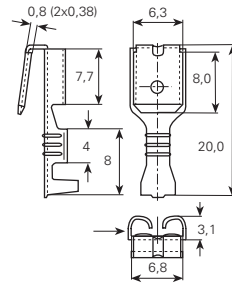
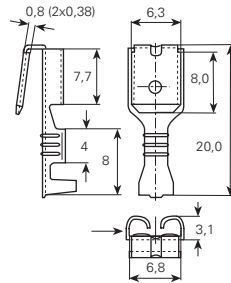
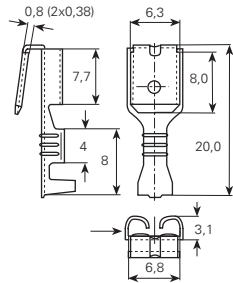

Artikelnummer  
Numéro d'article  
Part-No.  
Größe  
Grandeur  
Size

**3838a.2**

6.3 x 0.8 / 6.3 x 0.8

mm<sup>2</sup> **0.5-1.5**

AWG 22-16

Werkzeuge  
Outils  
Toolings

**3983p.4, 3984a, 3988n**

**3838a.6**

6.3 x 0.8 / 6.3 x 0.8

mm<sup>2</sup> **0.5-1.5**

AWG 22-16

**3983p.4, 3984a, 3988n**

**3838b.2**

6.3 x 0.8 / 6.3 x 0.8

mm<sup>2</sup> **1.5-2.5**

AWG 16-14

**3975c, 3983p.4, 3984a, 3988n**

**3838b.6**

6.3 x 0.8 / 6.3 x 0.8

mm<sup>2</sup> **1.5-2.5**

AWG 16-14

**3975c, 3983p.4, 3984a, 3988n**

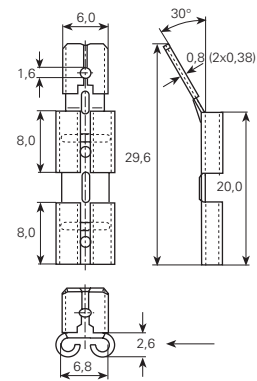
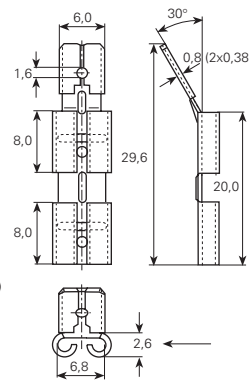
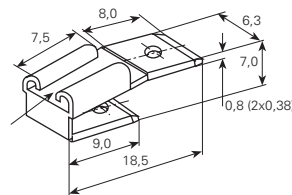
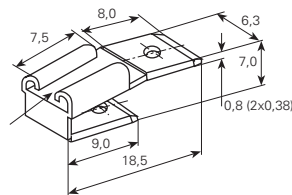

Artikelnummer  
Numéro d'article  
Part-No.  
Größe  
Grandeur  
Size

**3838.2**

6.3 x 0.8 / 6.3 x 0.8

mm<sup>2</sup>

AWG

Werkzeuge  
Outils  
Toolings

**3838.6**

6.3 x 0.8 / 6.3 x 0.8

mm<sup>2</sup>

AWG

**3838d.6**

6.3 x 0.8 / 6.0 x 0.8

mm<sup>2</sup>

AWG

**3838d.9**

6.3 x 0.8 / 6.0 x 0.8

mm<sup>2</sup>

AWG



# Steckhülsen und Steckverteiler 6,3 mm

## Clips femelles et raccords mixtes

### Receptacles and multi connectors

Masse im Steckbereich DIN  
46342, Teil 1

Dimensions zone  
d'emboîtement selon DIN  
46342, partie 1

Dimensions in the tab sector  
DIN 46342, part 1

Werkstoff/Matière/Material  
.2 = Bronze/bronze  
.4 = Kupfer/cuivre/copper  
.6 = Messing/laiton/brass  
.8 = rostfreier Stahl/acier inox/stainless steel  
.9 = Stahl/acier/steel

■ = Oberflächen/Surface/Surface-plating  
Seite/page/page 5.011

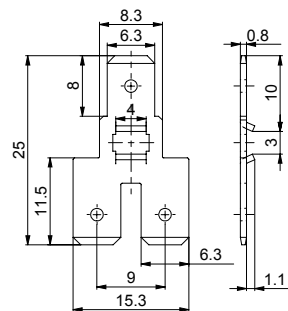
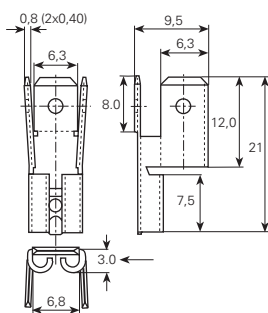
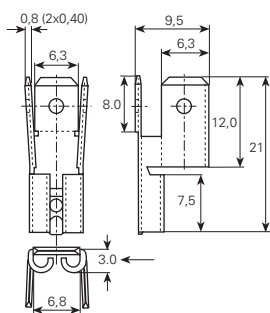

Artikelnummer  
Numéro d'article  
Part-No.  
Größe  
Grandeur  
Size

**3838e.6**  
6.3 x 0.8 / 6.3 x 0.8

mm<sup>2</sup>  
AWG

Werkzeuge  
Outils  
Toolings

**3838e.9**  
6.3 x 0.8 / 6.3 x 0.8

mm<sup>2</sup>  
AWG

**3838g.6**  
6.3x0.8 / 6.3x0.8 / 6.3x0.8

mm<sup>2</sup>  
AWG

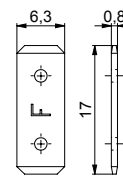
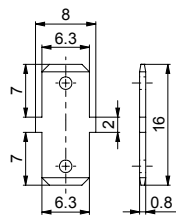
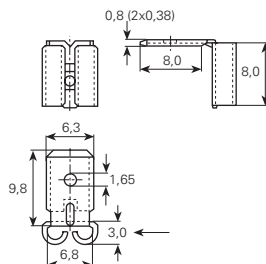
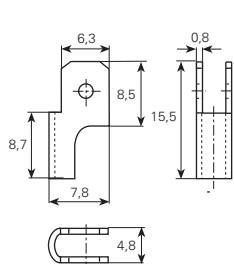

Artikelnummer  
Numéro d'article  
Part-No.  
Größe  
Grandeur  
Size

**3839.80**  
6.3 x 0.8 / 6.3 x 0.8

mm<sup>2</sup>  
AWG

Werkzeuge  
Outils  
Toolings

**3839f.6**  
6.3 x 0.8 / 6.3 x 0.8

mm<sup>2</sup>  
AWG

**3839k.6**  
6.3 x 0.8 / 6.3 x 0.8

mm<sup>2</sup>  
AWG

**3875f.4**  
6.3 x 0.8 / 6.3 x 0.8

mm<sup>2</sup>  
AWG