

**SMD Stanzteile**  
**SMD Pièces estampées**  
**SMD Stamping parts**

Werkstoff/Matière/Material  
 .2 = Bronze/bronze  
 .4 = Kupfer/cuivre/copper  
 .6 = Messing/laiton/brass

■ = Oberflächen/Surface/Surface-plating  
 Seite/page/page 5.011

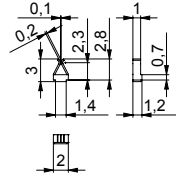

Artikelnummer  
 Numéro d'article  
 Part-No.

400.2■

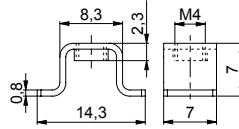

408.6■

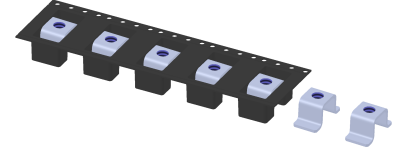

40806■

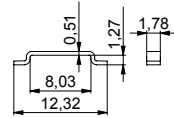

Artikelnummer  
 Numéro d'article  
 Part-No.

410.4■

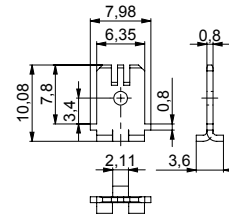

450.6■

■ = Oberflächen/Surface/Surface-plating  
 Seite/page/page 5.011

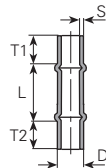

**Doppelbundhülsen**

**douilles à deux collets**

**double collar sleeve**

Werkstoff/Matière/Material:  
 6 = Messing/laiton/brass

øD mm	S mm	L mm	T1 mm	T2 mm	Artikelnummer Numéro d'article Part-No.	øD mm	S mm	L mm	T1 mm	T2 mm	Artikelnummer Numéro d'article Part-No.
1.5	0.3	4.5	2	2	w1504520206■	2	0.3	55	3	3	w2055030306■

Andere Abmessungen auf Anfrage

Autres dimensions sur demande

Further dimensions on request