

Werkstoff/Matière/Material  
 .2 = Bronze/bronze  
 .6 = Messing/laiton/brass  
 .7 = Neusilber/mailechort/german silver

■ = Oberflächen/Surface/Surface-plating  
 Seite/page/page 5.011

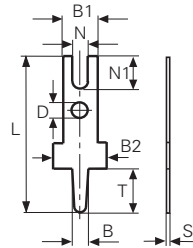

lose  
en vrac  
in bulk

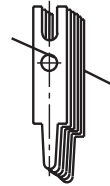

magaziniert  
emmagasiné  
wired

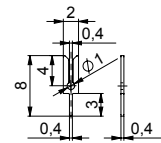
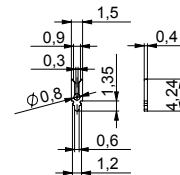
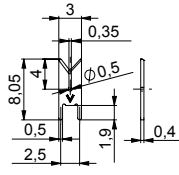
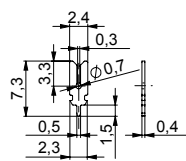
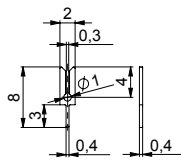

Artikelnummer  
Numéro d'article  
Part-No.

Bohrung/Trou/Hole

**1005x.7**

∅ 0.4  
T 3  
L 8  
S 0.4

**1005d.2**

∅ 0.5  
T 1.5  
L 7.3  
S 0.4

**1005w.2**

∅ 0.5  
T 1.9  
L 8.05  
S 0.4

**1005u.2**

∅ 0.6  
T 0.75  
L 4.24  
S 0.4

**1005t.7**

∅ 0.5  
T 3  
L 8  
S 0.4

Werkzeuge  
Outils  
Toolings

**9**

**62**

**95**

**56**

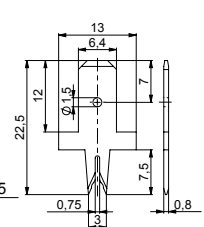
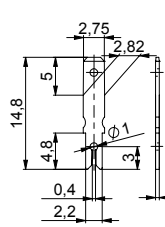
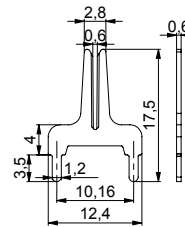
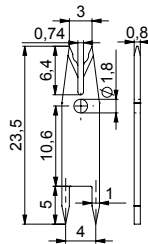
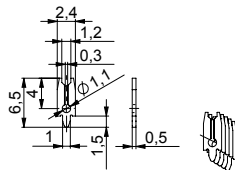

Artikelnummer  
Numéro d'article  
Part-No.

Bohrung/Trou/Hole

**1005c.6**

∅ 0.9  
T 1.5  
L 6.5  
S 0.5

**01005c.6**

∅ 0.9  
T 1.5  
L 6.5  
S 0.5

**1003ab.6**

∅ 1.1  
T 5  
L 23.5  
S 0.8

**1003q.2**

∅ 1.2  
T 3.5  
L 17.5  
S 0.6

**3770r.6**

∅ -  
T 4.8  
L 14.8  
S 0.5

**3875k.6**

∅ -  
T 7.5  
L 22.5  
S 0.8

Werkzeuge  
Outils  
Toolings

**19**

**1047c**

**41**

**62**